

# WELCOME TO BETHEL!

We at Bethel extend a warm welcome to those worshipping with us today! Please join us for coffee, tea, and conversation in the Tea & Coffee Lounge after the service.

We welcome children to stay for the entire service and worship alongside us. If you are concerned that your child may get restless, we offer nursery childcare as well as rooms for nursing mothers during morning and evening worship. Our nursery is located just off of the Tea & Coffee Lounge.

## WELCOME, VISITORS!

We're so glad you joined us for worship today. For a free gift, come to the Welcome Center. We would love to get to know you better!



Please scan the QR code and let us know how we can best serve you.

If you need a Bible of your own, please visit our Welcome Center outside the sanctuary; hospitality volunteers will be able to provide you with one.

**Personal PA receivers** are available during the service for those that are hard of hearing; please ask an usher if you could benefit from one.

For more info on Bethel, stop by our Welcome Center in the foyer.

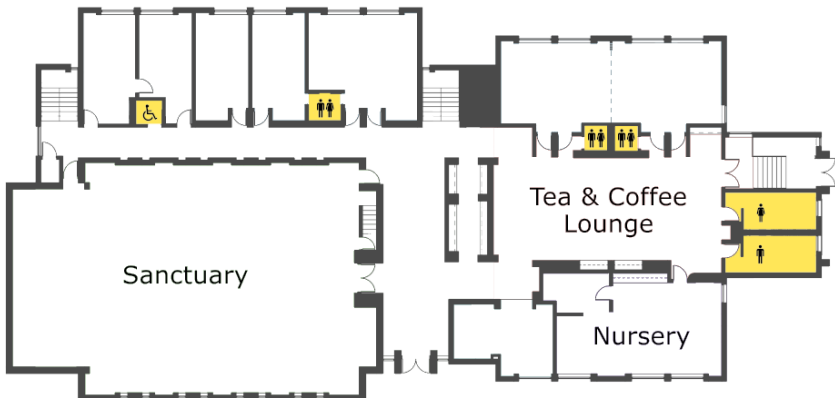

# THE ORDER OF WORSHIP

Aug 14, 2022

9:30 am

The Prelude

Welcome & Announcements

## THE SERVICE OF APPROACH TO GOD

\*The Salutation

\*The Call to Worship

\*The Opening Hymn

100

*Holy, Holy, Holy!*

\*The Invocation

\*The Confession of Faith Heidelberg Catechism #1

*Q.: What is your only comfort in life and death?*

A.: That I, with body and soul, both in life and death, am not my own, but belong to my faithful Savior Jesus Christ; who with his precious blood has fully satisfied for all my sins, and delivered me from all the power of the devil; and so preserves me that without the will of my heavenly Father not a hair can fall from my head; yea, that all things must be subservient to my salvation, wherefore by his Holy Spirit he also assures me of eternal life, and makes me heartily willing and ready, henceforth, to live unto him.

The Confession and Assurance

The Law of God

James 2:8-13

The Prayer of Confession

The Declaration of Pardon

1 Peter 2:24-25

\*The Hymn of Thanksgiving

94

*How Firm a Foundation*

The Reception of New Member

*\* Please stand, if you are able*

## THE SERVICE OF THE WORD OF GOD

The Scripture

The Old Testament Lesson

Psalm 119:9-16

*pg. 650*

The New Testament Lesson

James 1:18-27

*pg. 1289*

Leader:

*This is the Word of the Lord.*

People:

*Thanks be to God.*

The Sermon “Growing in Christ through the Word *part 1*”

(James 1:18-21)

*Dr. Deryck Barson*

## THE SERVICE OF RESPONSE TO GOD

\*The Hymn of Response

PH 172

*Speak, O Lord*

The Intercessory Prayer

Our Father in heaven, hallowed be your name. Your kingdom come, your will be done, on earth as it is in heaven. Give us this day our daily bread, and forgive us our debts, as we also have forgiven our debtors. And lead us not into temptation, but deliver us from evil. For yours is the kingdom and the power and the glory, forever. Amen.

The Offering and Offertory

*Please pass the Friendship Pad, located at the center aisle.*

\*The Doxology and Prayer of Dedication

733

\*The Closing Hymn

347

*The Church's One Foundation*

\*The Benediction

\*The Postlude

# BETHEL TODAY

SUNDAY, AUG 14, 2022

**9:30 am            Morning Worship**

Deryck Barson is preaching. Diane Chou is the pianist.

**11:15 am            Sunday School**

**The Ancient Church: A Survey**

*This class will meet in the sanctuary.*

Many committed, knowledgeable Christians still know little about the history of the church. As a result, we miss a testament to God's faithfulness throughout the centuries and the demonstration of God's promise to build and preserve his church so that "the gates of hell will not prevail against it." (Matt. 16:18)

This 12-week course will combine DVD lectures and in-person teaching to introduce the ancient church, endeavoring to connect the past to the present by showing how understanding heretical beliefs and creedal orthodoxy can help us defend the faith and navigate the theological issues in our contemporary world. This class will be led by Dan Schrock and Ben Thocher.

**12:00 pm            Fellowship Dinner**

**5:30 pm            Evening Worship**

Dr. Schrock's sermon is from Deuteronomy 18:9-22, "O Word of God Incarnate."

## THIS WEEK AT BETHEL

Aug 17	7:00 pm	Trustee Meeting
Aug 19	5:30 pm	Board Games & Kids' Movie Night
Aug 20	10:00 am	Conversations & Crafts

## COMING IN BETHEL

### **Preaching Schedule for Aug 21:**

Morning worship: Dr. Daniel Schrock

Evening Worship: Dr. Deryck Barson

Aug 21	12:00 pm	College Hot Dog Roast
Aug 22	7:00 pm	Diaconate Meeting

### **Music Schedule for Aug 21:**

Morning Accompanist: Kathy De Jong

Offertory Music: Andrew Pressley

Evening Accompanist: Kathy De Jong

### **Please mark your calendars for some upcoming events!**

Sep 10	Men's Breakfast
Oct 21	Marriage Seminar by Chad & Emily Van Dixhoorn
Oct 22	Reformation Lecture by Chad Van Dixhoorn
Oct 29	Fall Festival

For a look at more of what's happening in the life of Bethel, please visit our website: [bethelopc.org](http://bethelopc.org) and click the calendar button at the top, or go to [bethelopc.org/calendar](http://bethelopc.org/calendar).

## BETHEL PRESS

**New Member Reception.** The session is pleased to announce that it will publicly receive the following into communicant membership this morning:  
Jane Gregga by letter of transfer

**Congregational Meeting.** A congregational meeting will be held on Sunday, August 21st, following the evening service.

**Thank you!** The outreach committee would like to thank all who generously donated to Bethel's first annual backpack drive, and participated in the Bethel backpack giveaway on Thursday, August 4th. We collected 95 backpacks filled with school supplies and were able to find happy homes for all of them! Many families came to Bethel and heard the gospel, experienced the love of Christ, and had meaningful interactions with Bethel members. We hope to share more detailed testimonies in the future and are grateful for God's faithfulness!

**Youth Leaders Needed.** The youth committee is looking for additional youth leaders to help out during the upcoming school year. Bethel members who are college-aged or older are welcomed, and compliance with Bethel's Child Protection Policy is required. Involvement includes Sunday evening meetings twice a month throughout the school year, as well as occasional events. If interested, please reach out to the church office or to Matt or Kate Schuman, [kateschuman11@gmail.com](mailto:kateschuman11@gmail.com). We appreciate your consideration as we seek to build relationships and strengthen faith in our covenant youth

**Attention Bethel Bakers.** If anyone would be interested in providing a homemade dessert for our once-a-month college fellowship luncheon, please notify Barb LoRusso at [frombarbara@gmail.com](mailto:frombarbara@gmail.com) to be added to our list of bakers. Luncheons begin in September and run through May. We will be happy to schedule you for any dates that would work

**Back to School Movie & Game Night.** The fellowship committee invites the congregation for a movie and game night on Friday, August 19th at 5:30pm! Movie will start at 6 and popcorn will be provided for the children, but please bring something comfy for them to sit on and a spill proof water bottle. All adults are welcome to join us for a game time; please feel free to bring a snack or a game to share. If you have any questions, please call or text Rachel, 515-401-8806

*\*\* If you have an announcement for the bulletin, please send it to Katherine Czerwinski, [Katherine.czerwinski@bethelopc.org](mailto:Katherine.czerwinski@bethelopc.org) by Tuesday for it to be included the following Sunday.*

**Parents of Sunday School students** age 2 through fifth grade, after the morning service please supervise your child(ren) until singing begins downstairs at approximately 11:00. Feel free to take them outside to run or get fresh air, bring them to the 10:10 Catechism Club table downstairs to recite their catechism questions, or accompany them to the snack window downstairs for a snack. Once singing time begins you can leave your child to sing and to go to Sunday School class. You' re also welcome to stay and sing! If your child isn't attending singing time, he or she will need to remain with you. At 11:15 after singing, adults will accompany the youngest children to the upstairs classes and older students will walk to class on their own. Please see Ben Thocher or Kim Sceggel if you have any questions. Thanks so much for your help with this!

**Midwest Presbytery Volunteers.** Bethel will be hosting the Midwest Presbytery meetings on September 16-17. The Fellowship Committee is seeking volunteers to help with food, serving, and lodging needs. If you are available to serve, please email [Katherine.czerwinski@bethelopc.org](mailto:Katherine.czerwinski@bethelopc.org).

**Nature Camp Coordinator.** The outreach committee is searching for one or more volunteers to serve as Nature Camp coordinators for the coming year. The Nature Camp coordinators are responsible for the administration of camp. Duties can be split between multiple volunteers; if you have interest, please contact the office or Shari Czerwinski, [czer513@gmail.com](mailto:czer513@gmail.com).

## NOTES